

REQUIRED TOOLS:

- Cross line laser (recommended)
- Spirit laser
- Impact drill + 6mm drill piece (wall installation for implementing the profiles' wall holes)
- Screw gun + 3.2 – 3.5 mm drill piece (for implementing 4 x 20 RH screw holes)
- Assy tip AW20 (for 4 x 20 RH , 4 x 40 RH , 3.5 x 30 CSKH screws) + Phillips tip PHR2 or PH2 (for 3.8 x 41 CSKH screws)
- Hacksaw (for cutting upper profiles)
- File (for filing sawed profiles)
- Support block with a height of the floor gap or scissor jack (as support between the floor and the board)
- Chisel (for preparing lock indentation)
- Tape measure
- Phillips screwdriver or Phillips tip PZ2 (for installing bushings)
- Small spanner (for adjusting adjustment legs)

GENERAL:

The partition walls are delivered on pallets on to which they have been packed, and protected with protection boards and paper, which protect the sensitive laminate surfaces during transport and storage. The pallets should not however be left outdoors in the rain or snow. The aluminium profiles and bushings are delivered as separate packages.

LABELLING:

The aluminium profiles have been packaged in filmed bundles and a plastic tie room-specifically, and the room numbers have been indicated on the bundles.

The board elements have been labelled as follows:

OL = Door board

The door opening direction (left- or right-handed) has been indicated:

+ = left-handed, opens to the left

++ = right-handed, opens to the right

ES = Front wall board

VS = Partition wall board

SS = Shower wall

PS = Urinal wall

YL = Upper board, in all cubicles that are higher than normal and have an upper piece (extension piece)

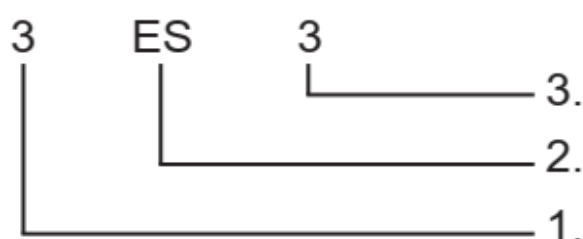

wc3 VS2
600 * 1980

1. Room number

Each room which will have a partition wall has a room number. The room number is also indicated on all wall boards and profile wood.

2. Element code

3. Element order number

Elements that are of different sizes, have the same code and are for the same room, have been labelled with an order number. The element's dimensions (width x height) are specified under these.

ERECTION OF PARTITION WALLS:

1. Fix the aluminium profiles (1) length 1955 mm to the room's walls, for the partition walls and outermost front wall boards. Use 6mm plugs and 4 x 40 RH screws.

Note: Find the highest point from the floor as measured from the front wall or possible partition wall's extension, and use this point to measure 120 mm with the laser to where the wall mounting profiles (1) are fixed, (if the inclination of the floor is greater, the measurement can be 5 mm lower). The upper ends of all the wall mounting profiles must be at the same height.

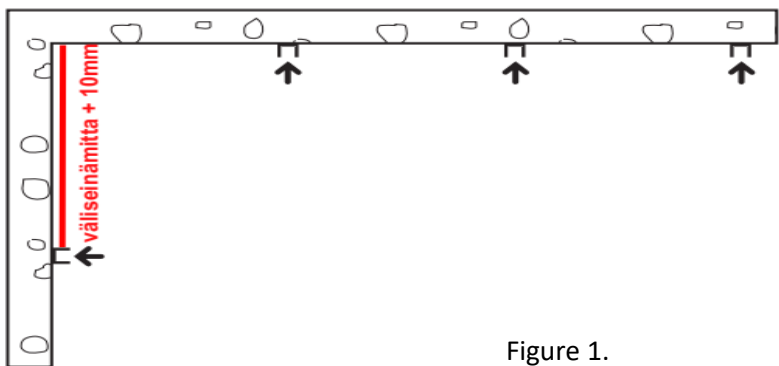
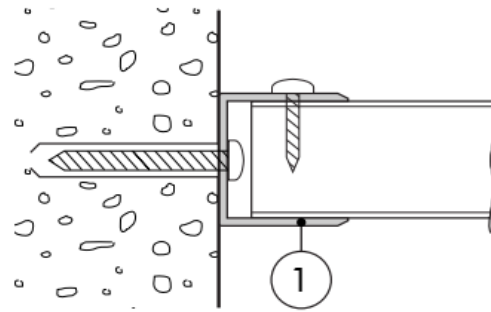

Figure 1.



Mounting to the wall of room.

2. Lift the partition walls into place in a vertical position (using the spirit level) and fix them to the aluminium profiles with 4 x 20 RH screws. A floor-height (standard 120 mm) support block or scissor jack is placed at the front edge under the boards.

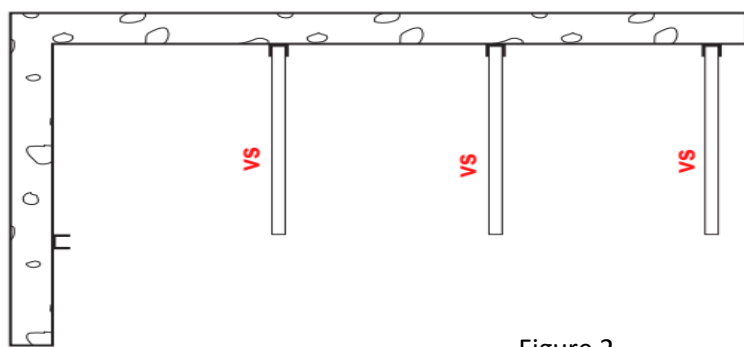
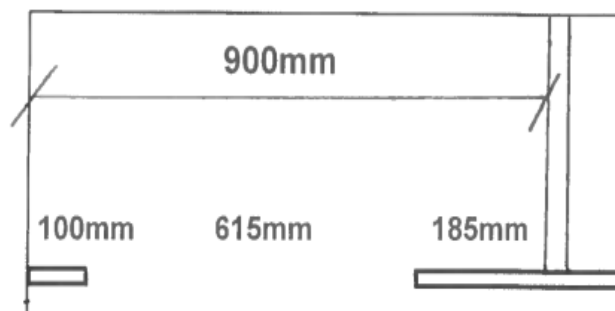

Figure 2.

Example calculation for the location of the partition wall.



3. Fix the aluminium profiles (1), length 1955 mm to the front wall boards for the partition walls with 4 x 20 RH screws. (You can find a place for it by measuring the inner dimensions of the cubicle - the board inside the cubicle (ES) – 615mm, e.g. if the width of the cubicle is 900 mm and the board inside the cubicle is 100 mm, the place for the next profile is $900 \text{ mm} - 100 \text{ mm} - 615 \text{ mm} = 185 \text{ mm}$. The lower ends of the profile and the front wall board are aligned.

4. Lift the front wall boards into place and fix them to the partition walls with 4 x 20 RH screws. Fix the ES1, i.e. the left-hand front wall, to the profile on the side wall using 4 x 20 RH screws. If you are assembling the group from left to right, the door openings should be approx. 615 mm wide at this stage.

The front walls are fixed to a height where a horizontal profile (1) can be fixed to their upper edge with the opening downwards (best results are achieved by using a laser to ensure that the front walls are aligned). If the front wall does not reach from wall to wall, but instead forms a so-called open corner, an aluminium profile (3) is placed here.

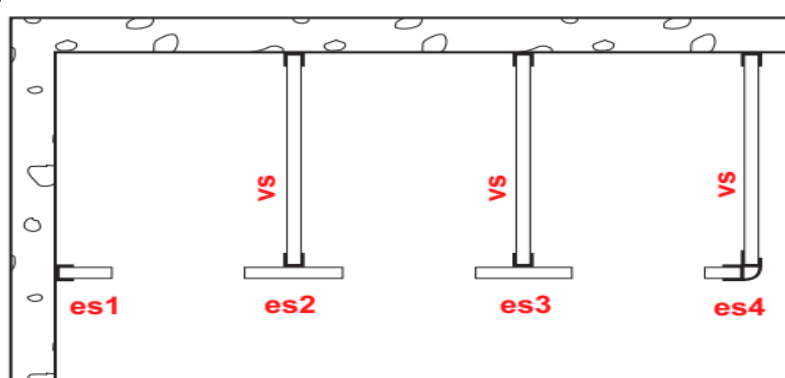
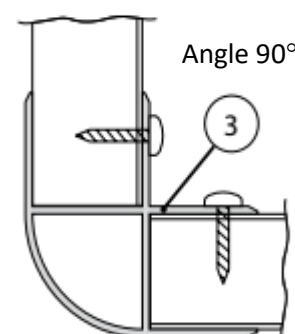

Figure 3.



5. Saw the upper profile to the right length. Fix it to the upper edge of the front wall with 4 x 20 RH screws (holes must be drilled to the profile for the screws). **AT THE SAME TIME ENSURE THAT THE MEASUREMENT OF THE DOOR OPENINGS FROM THE UPPER PART IS 615 mm WHEN YOU SCREW THE BOARDS IN PLACE FROM LEFT TO RIGHT.**
6. Turn the screws of the adjustment feet into the plastic nuts at the ends of the door profiles (2). Mark the locations of the adjustment feet's' washers on the floor with the help of the door profile (2). **ENSURE THAT THE MEASUREMENT OF THE DOOR OPENINGS FROM THE LOWER PART IS 615 mm (WITH THE PROFILES, THE MEASUREMENT MUST BE 612 mm).** Clean the floor and glue the adhesive washer to the floor **FROM LEFT TO RIGHT** (the washers have an adhesive sticker).
7. Fix the profiles (2) to the door openings with 3.5 x 30 CSKH screws, the hinge-side profile with two screws and the lock-side profile with four screws. **Note:** The day-care profiles do not have screw places, but instead they are drilled at the construction site and screwed from the inside of the cubicle with 4 x 20 RH screws. At the same time, fix the last jamb piece to the wall and upper profile and measure to ensure that the width of the last door opening is also **615 mm (WITH THE PROFILE 612mm)**. Thereafter the cover profile (7) is pressed on to the U profile above the door opening.

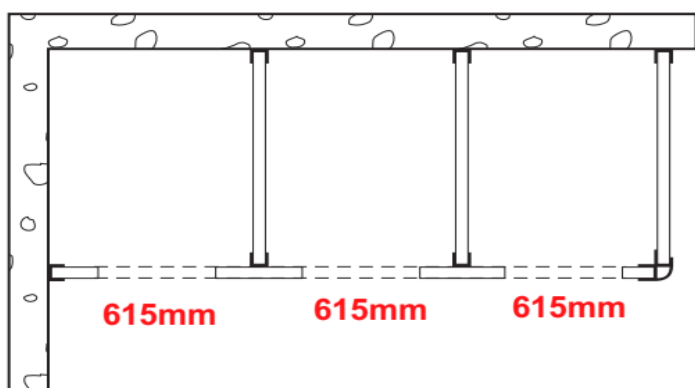
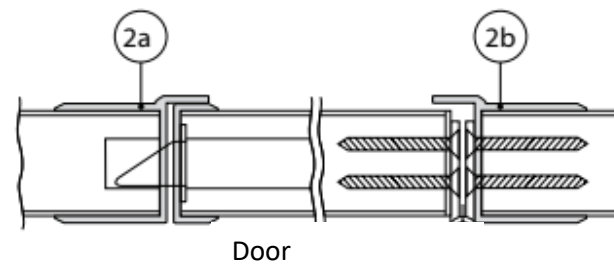

Figure 4.



8. Screw the hinges in the doors (pre-drilled screw holes)
9. Fix the door boards with 3.8 x 41 CSKH screws
10. Fix the lock and lock cover plate to the doors with 3.8 x 41 CSKH screws
11. Fix the doors' buttons and knobs
12. Use the chisel to make indentions to the jamb pieces for the lock tongues

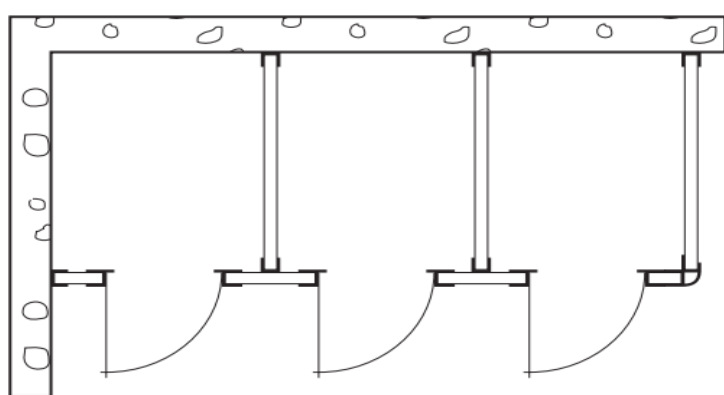
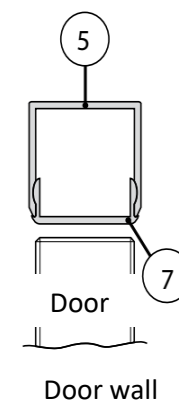
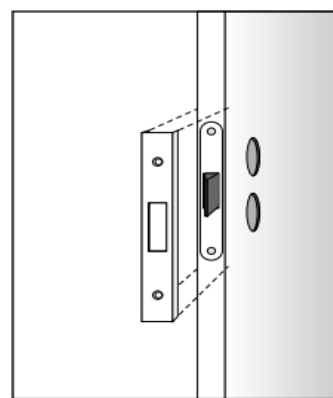
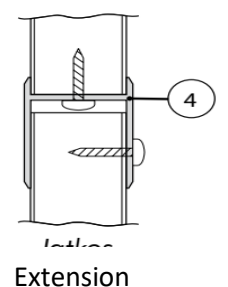

Figure 5.



13. Ensure the access gaps of the doors and adjust them where necessary with the adjustment feet

NOTE! ONLY 30 mm OF THE ADJUSTMENT FOOT IS INTENDED TO BE VISIBLE, BUT IF THERE ARE INCLINATIONS OF THE FLOOR, THEY REQUIRE ADJUSTMENT



NOTE! If extensions are added to the partition walls, they are fixed with an H profile (4), which do not have screw holes, but instead they are drilled at the construction site and first fixed with 4x40 RH screws from the "inside" and then with 4 x 20 RH screws from the side to the extension piece. They are fixed to the floor with adjustment feet.

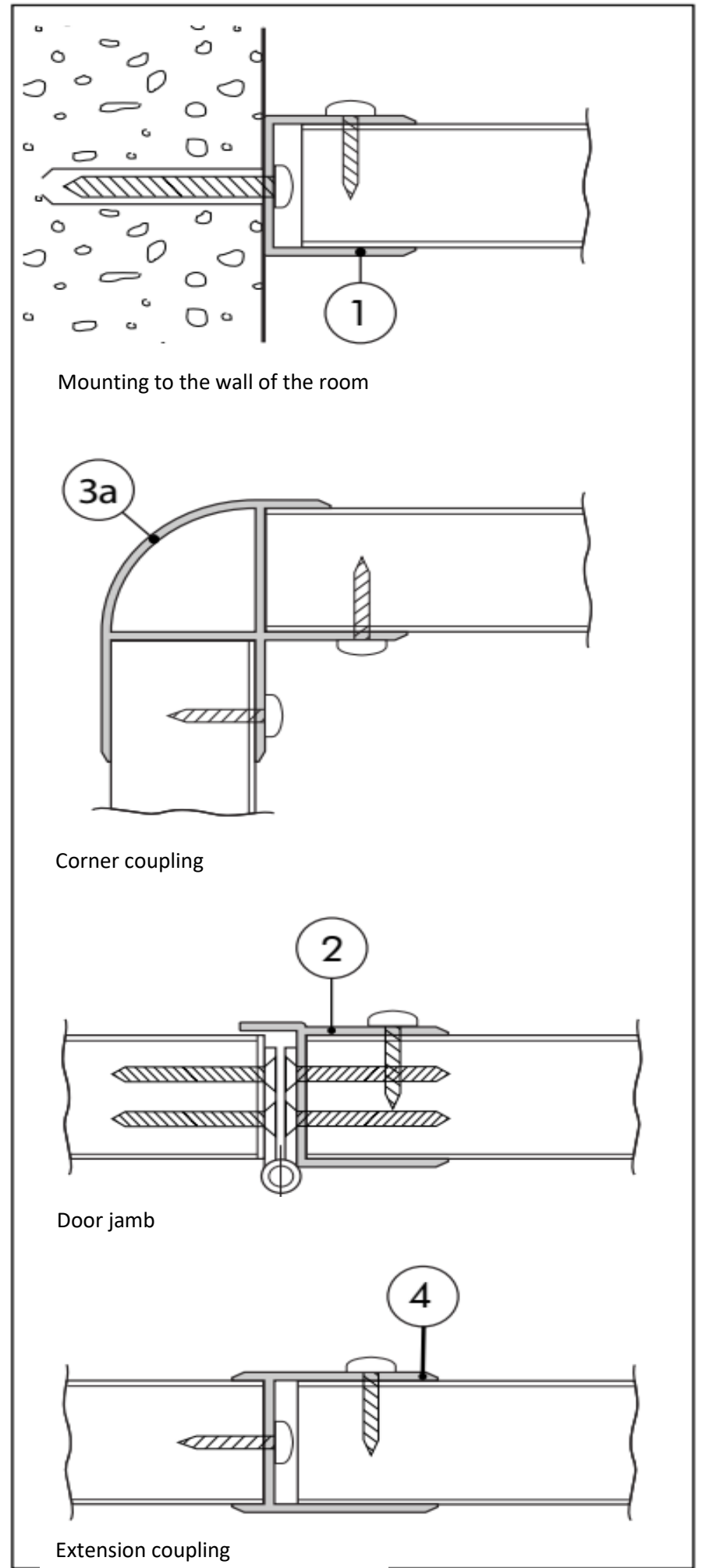
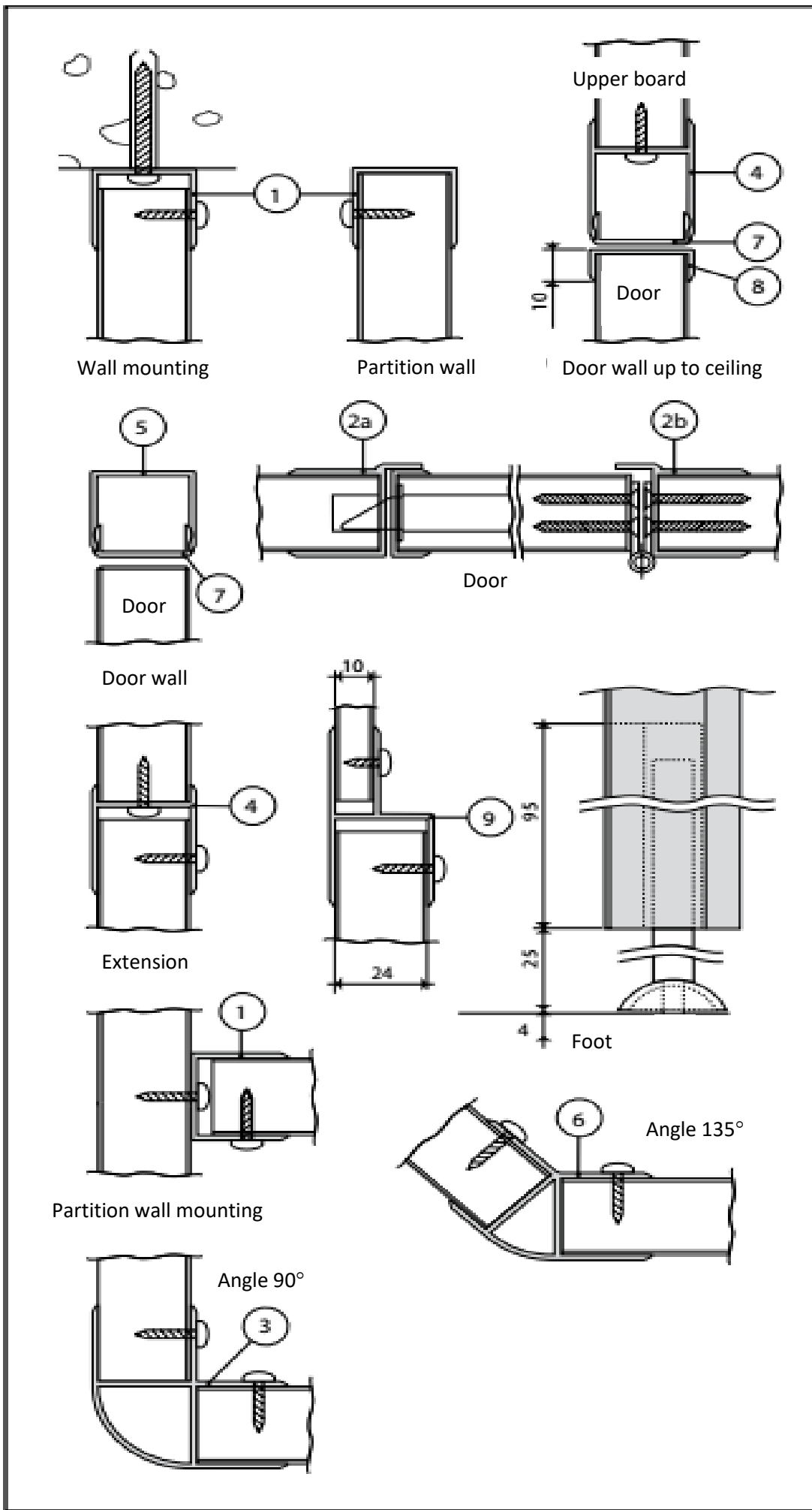

Measuring extension wall cubicles with doors

Measuring shower partition walls

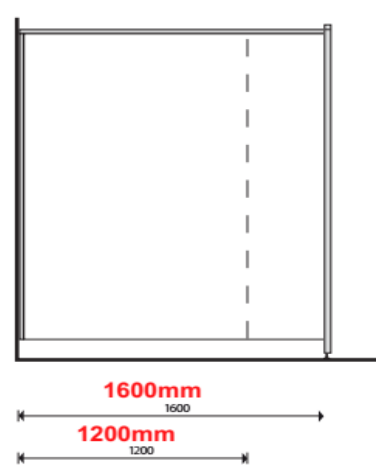
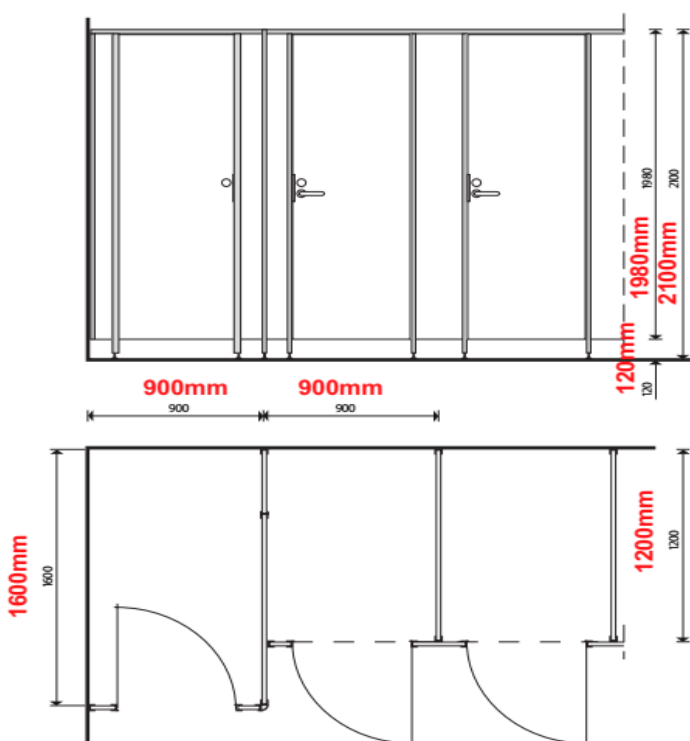

ELTETE LTT CUBICLES

info@eltete.com
+358 (0) 10 505 6400
www.eltete.com